

# 分筆予定図

# 虻田郡二セコ町字曾我

地番	①878-5			
NO	Xn	Yn	Yn+1-Yn-1	Xn · (Yn+1-Yn-1)
A1	-129277.453	34318.833	-2.772	358357.099716
A2	-129285.861	34335.936	24.905	-3219864.368205
10-199	-129254.739	34343.738	2.772	-358294.136508
10-198	-129237.029	34338.708	-24.905	3218648.207245
合計				-1153.197752
合計面積				576.5988760
地積				576.59 m <sup>2</sup>

地番	⑦878-			
NO	Xn	Yn	Yn+1-Yn-1	Xn · (Yn+1-Yn-1)
B1	-129416.860	34274.573	-18.139	2347492.423540
00843	-129420.473	34276.176	15.863	-2052996.963199
00846	-129412.727	34290.436	20.636	-2670561.034372
00845	-129426.310	34296.812	10.039	-1299310.726090
10-226	-129422.870	34300.475	-2.497	323168.906390
10-225	-129410.620	34294.315	-25.902	3351993.879240
合計				-213.514491
合計面積				106.7572455
地積				106.75 m <sup>2</sup>

地番	②878-			
NO	Xn	Yn	Yn+1-Yn-1	Xn · (Yn+1-Yn-1)
A1	-129277.453	34318.833	-25.149	3251198.665497
10-201	-129293.819	34310.787	-13.914	1798994.197566
A3	-129306.830	34304.919	30.671	-3965969.782930
A4	-129322.386	34341.458	26.878	-3475927.090908
10-200	-129302.369	34331.797	-5.522	714007.681618
A2	-129285.861	34335.936	-12.964	1676061.902004
合計				-1634.427153
合計面積				817.2135765
地積				817.21 m <sup>2</sup>

総合計面積 4974.5917080 m<sup>2</sup>

地番	面積
①878-5	576.5988760 m <sup>2</sup>
②878-	817.2135765 m <sup>2</sup>
③878-	1212.3228980 m <sup>2</sup>
④878-	1064.6973390 m <sup>2</sup>
⑤878-	650.5204215 m <sup>2</sup>
⑥878-	546.4813515 m <sup>2</sup>
⑦878-	106.7572455 m <sup>2</sup>

地番	③878-			
NO	Xn	Yn	Yn+1-Yn-1	Xn · (Yn+1-Yn-1)
A12	-129349.630	34286.656	27.158	-3512877.251540
A13	-129363.131	34318.369	65.610	-8487515.024910
10-208	-129344.780	34352.266	23.089	-2986441.625420
A4	-129322.386	34341.458	-47.347	6123027.009942
A3	-129306.830	34304.919	-37.279	4820429.315570
10-317	-129308.471	34304.179	26.863	-3473613.456473
10-316	-129320.223	34331.782	19.819	-2562997.499637
10-319	-129338.505	34323.998	-12.968	1677261.732840
10-364	-129350.682	34318.814	-32.787	4241020.810734
10-363	-129338.931	34291.211	-32.158	4159281.343098
合計				-2424.645796
合計面積				1212.3228980
地積				1212.32 m <sup>2</sup>

面積表

地番	計画面積	確定面積
①878-5	576.67	576.59
②878-	816.45	817.21
③878-	1535.51	1212.32
③878-、878-6 + 878-7		2205.44
④878-	641.11	1064.69
⑤878-	650.42	650.52
⑥878-	551.54	546.48
⑦878-	384.73	106.75

地番	④878-			
NO	Xn	Yn	Yn+1-Yn-1	Xn · (Yn+1-Yn-1)
A10	-129390.883	34269.095	7.388	-955939.843604
A11	-129401.504	34294.044	24.211	-3132939.813344
10-209	-129376.700	34293.306	24.325	-3147088.227500
A13	-129363.131	34318.369	-6.650	860264.821150
A12	-129349.630	34286.656	-49.274	6373573.668620
合計				-2129.394678
合計面積				1064.6973390
地積				1064.69 m <sup>2</sup>

地番	⑤878-			
NO	Xn	Yn	Yn+1-Yn-1	Xn · (Yn+1-Yn-1)
A10	-129390.883	34269.095	-38.579	4991770.875257
10-217	-129422.900	34255.465	25.220	-3264045.538000
10-225	-129410.620	34294.315	38.579	-4992532.308980
A11	-129401.504	34294.044	-25.220	3263505.930880
合計				-1301.040843
合計面積				650.5204215
地積				650.52 m <sup>2</sup>

地番	⑥878-			
NO	Xn	Yn	Yn+1-Yn-1	Xn · (Yn+1-Yn-1)
10-217	-129422.900	34255.465	-5.329	689694.634100
10-220	-129452.200	34269.244	28.609	-3703497.989800
00844	-129438.273	34284.074	6.932	-897266.108436
00843	-129420.473	34276.176	-9.501	1229623.913973
B1	-129416.860	34274.573	-20.711	2680352.587460
合計				-1092.962703
合計面積				546.4813515
地積				546.48 m <sup>2</sup>

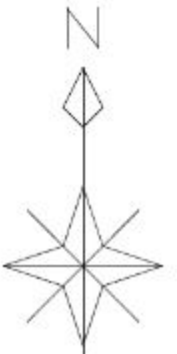
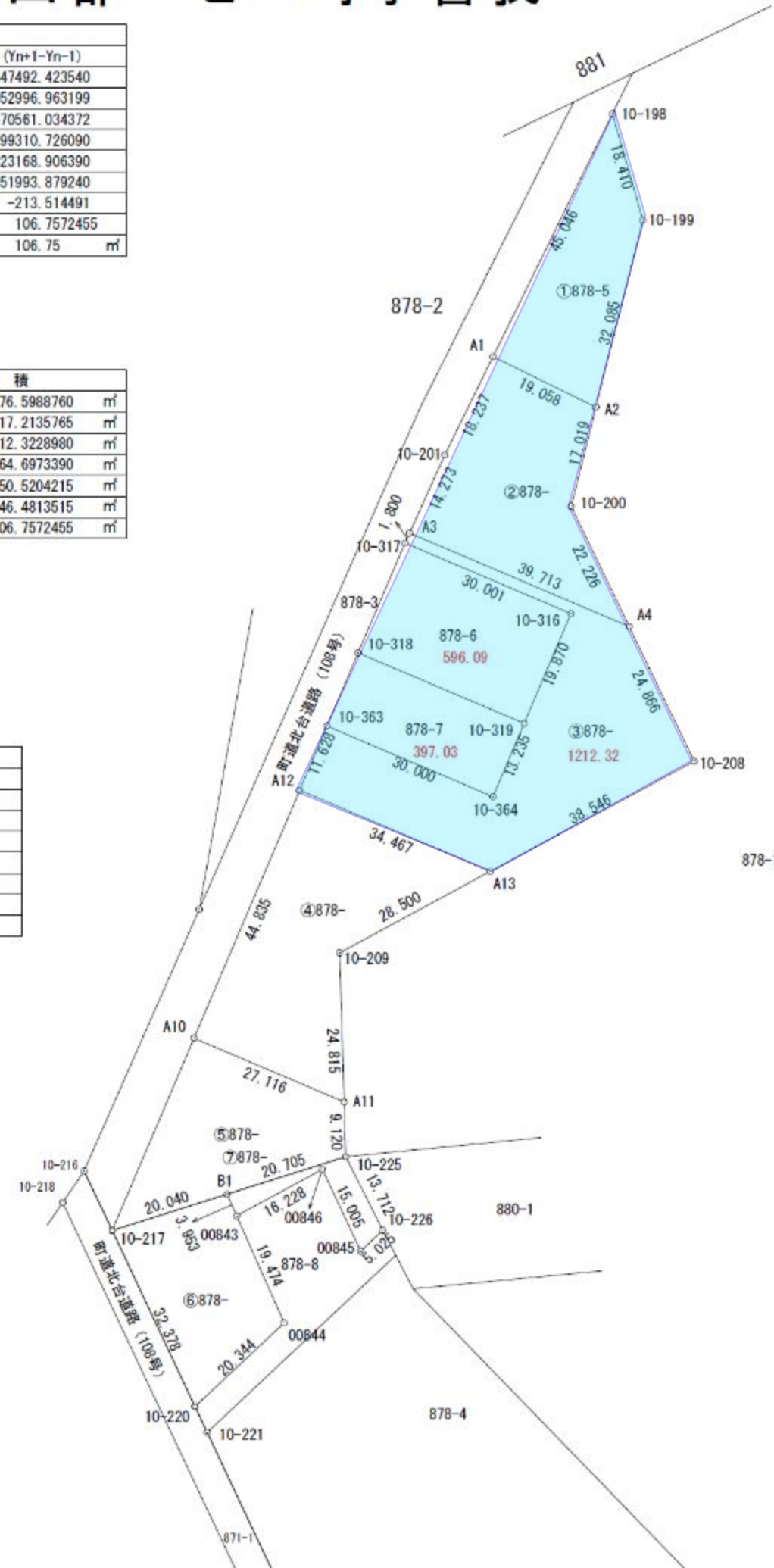

縮尺=1/1000